

# LA MARÉ

BAY HARBOR ISLANDS

## OVERVIEW

La Maré Residences Bay Harbor Islands is an exclusive collection of boutique buildings featuring expansive, light-filled modern living spaces and luxurious amenities, creating a singular way of living and a true sense of home right on the water in this peaceful enclave.

These homes are unique, luxury tropical villas vertically stacked in the sky right along the water. The large, pristine residences feature sprawling living areas, generous closet and storage spaces, waterfront views, and impeccable finishes along with refined amenities such as an extensive rooftop deck overlooking the water, complete with an infinity pool, outdoor summer kitchen, indoor multipurpose lounge for entertaining, and unparalleled privacy. With the bay right downstairs, residents can enjoy a paddle in their kayaks, get picked up by boat on the private boat slips, and relax among the tropical waterfront landscaping.

Featuring wrap-around, floor-to-ceiling glass windows in every home, the architecture is inspired by a contemporary aesthetic, with streamlined features, tropical elements, and natural materials such as sand-colored stone, travertine, and bleached woods, creating a resort-like feel.

## LOCATION

One of Miami's best-kept secrets, Bay Harbor Islands is a unique neighborhood that has it all—it is charming, walkable, on the water, and has a laid-back elegance you won't find anywhere else. The park-like surroundings and serene character of this community make it feel like a private island, while just moments away from Miami Beach, Downtown Miami, Design District, and Bal Harbour Shops for access to a full range of world-class dining, entertainment, shopping, and more.

This hidden gem boasts its robust collection of local restaurants and small businesses, parks and green spaces, a dedicated police force and fire station, and Ruth K. Broad Bay Harbor K-8 Center, one of the highest-ranked schools in Miami-Dade County.

Bay Harbor Islands is situated directly in the center of South Florida's major destinations to the north and the south, with proximity to everything from West Palm Beach to the Florida Keys.

## TEAM

### REGENCY DEVELOPMENT GROUP DEVELOPER

Regency Development Group is a family-run international company founded in Chicago. Since launching in 2004, Regency has dedicated nearly 20 years to planning and building a diverse range of quality properties.

### KOBI KARP ARCHITECTURE & INTERIOR DESIGN ARCHITECTURE

For over two decades, Kobi Karp Architecture and Interior Design has been providing unique, creative, and innovative design solutions to renowned clients internationally and domestically in hospitality, retail, and high-rise residential developments.

### DEBORA AGUIAR ARQUITETOS INTERIOR DESIGN

Based in Brazil, Debora Aguiar Arquitetos is a team of experienced architects, decorators, and interior designers, with 20 years of experience in the national and international market.

# BAY COLLECTION

**The Bay Collection is an oasis designed to stand apart for its beauty, sustainability, and overall sense of refined ease. This glass-clad modern building designed by Kobi Karp Architecture with a soft, natural interior palette features 9 residences.** The waterfront location offers boat slips, waterside amenities, and a landscaped rooftop pool deck.

The interiors are designed with the outdoors in mind. Large terraces function as outdoor rooms and create a true indoor-outdoor living experience. Glass-clad, with no solid walls to the outside, these residences are filled with abundant natural light and direct sea breezes that flow from room to room. The architect's intention with this design element is to reconnect to the natural environment, which is ideal for this prime bayfront setting.

*Boasting the best panoramic views of the bay from sunrise to sunset, Bay Collection embodies the epitome of Tropical Living.*

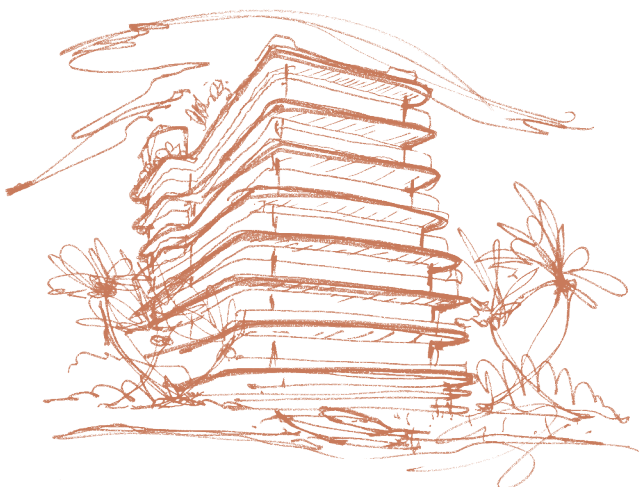

## RESIDENCE FEATURES

- Elegant, grand ceiling heights
- Panoramic bay views through floor-to-ceiling windows
- Private elevators bring residents directly to their homes with a key-lock system
- Custom Poliform kitchens with stone countertops featuring a top-of-the-line Miele appliance suite, including a coffee system and wine fridge
- Dual shower and deep soaking tub in primary bathrooms
- Elegant Italian fixtures in kitchens and bathrooms by Antonio Lupi

## BUILDING FEATURES

- Beautifully landscaped bayfront shoreline
- 9 stories with 9 expansive, light-filled residences, many featuring bay views
- Large glass-walled terraces perfect for entertaining
- 3- to 4-bedroom floor plan layouts ranging from 2,897 to over 5,389 sq. ft.
- Secured parking garage with ample parking
- Private boat slips available for residents
- Convenient private storage rooms for each residence

## BUILDING AMENITIES

- Bayfront outdoor space with landscaping, boat slips, and lounge areas
- Access to state-of-the-art fitness center
- Access to spa facility with steam and sauna
- Landscaped resort-like rooftop pool deck with infinity pool, jacuzzi, lounge chairs, and daybeds
- Rooftop bar and summer kitchen
- Welcoming entry lobby and lounge
- On-site doorman